



10231 Rose Blvd.  
Morrice, Michigan 48857  
**517-625-4590**

# VSG Series

# Dual Stage Grapples

## Compact Dual Stage Brush / Debris Grapples

### VSG Series Grapple Features:

- Designed Specifically for Compact Tractor Front End loaders (Up to 60 HP)
- Only Grapple on the Market Offering a Secondary Stage for Small Object Handling
- 32 1/2" Grapple Max Opening
- Clamps Down to 5" Diameter Objects With Secondary Stage Installed (See Spec Drawing on Next Page)
- Custom Color Configurations



### Standard Features:

- ◆ Abrasion Resistant Steel Tines
- ◆ Hydraulic Primary Stage Actuation
- ◆ Manual Secondary Stage Positioning
- ◆ Hydraulic Cylinder Shielding
- ◆ Grease-Able Zinc Plated Pivot Pins
- ◆ Skid Steer, JD or Direct Loader Pin-On

MODEL	BOTTOM WIDTH	NO. OF GRAPPLE TOPS	LIST PRICE	2ND STAGE ADDER
VSG-48S	48"	1	\$2175	\$595
VSG-60S	60"	1	\$2275	\$595
VSG-72S	72"	1	\$2375	\$595
VSG-60D	60"	2	\$2975	\$1150
VSG-72D	72"	2	\$3075	\$1150

OPTION	DESCRIPTION	LIST PRICE
CT-R	REPLACEABLE CUTTING TEETH	\$300
XM-VSG	EXPANDED METAL PROTECTION	\$225
SSH-VSG	SECONDARY STAGE HYDRAULICS	\$225 PER TOP



10231 Rose Blvd.

Morrice, Michigan 48857

**517-625-4590**

# VSG Series

# Dual Stage Grapples

## VSG Series Grapple Specifications

MODEL	GRAPPLE BOTTOM WIDTH	GRAPPLE WEIGHT ( S / D )
VSG-48	48"	349 LBS
VSG-60	60"	366 / 475 LBS
VSG-72	72"	381 / 487 LBS

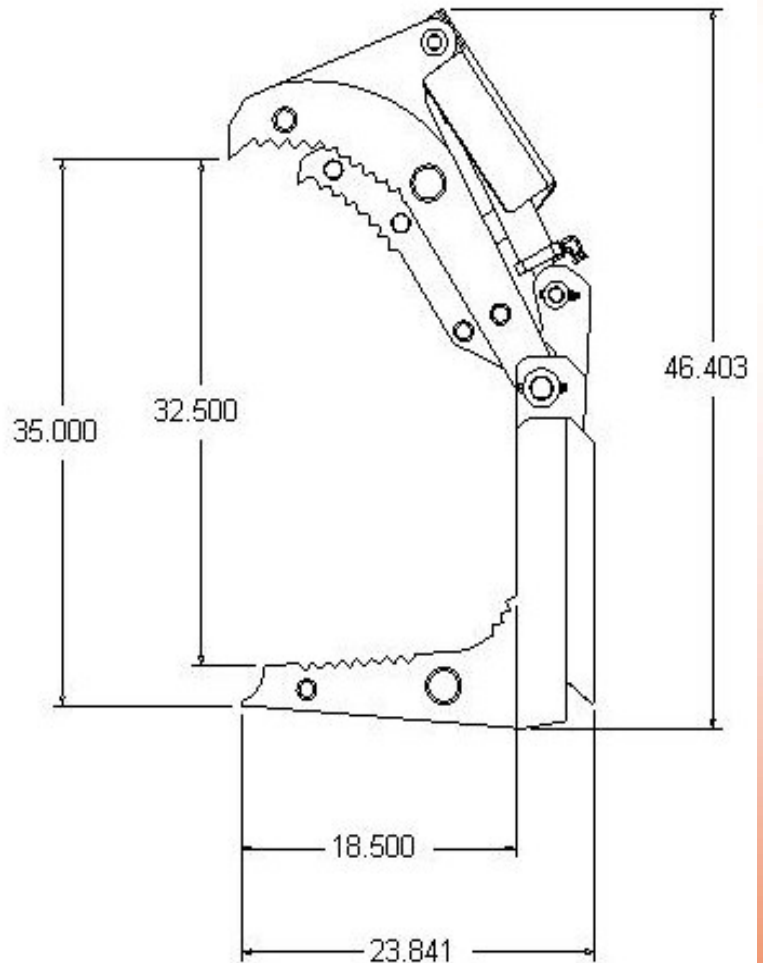
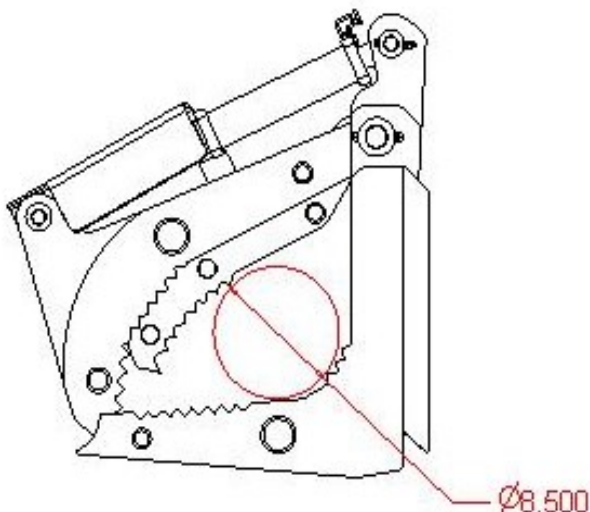
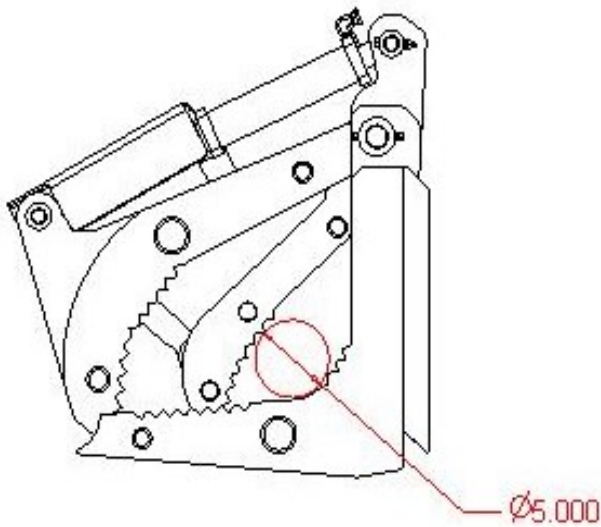

## VSG Series Grapple Dimensions